

PASSED

IN THE BOARD OF COUNTY COMMISSIONERS OF LANE COUNTY, OREGON

ORDER NO.

IN THE MATTER OF AUTHORIZING THE SALE OF SURPLUS COUNTY OWNED REAL PROPERTY TO MARK KIMBALL MATHIS FOR \$6,000 (MAP # 21-35-16-24-00500, OAKRIDGE)

03-1-21-7

WHEREAS this matter now coming before the Lane County Board of Commissioners and said Board deeming it in the best interest of Lane County to convey the following real property which was acquired through tax foreclosure, to wit:

Beginning at the Northwest corner of Maple Street as shown on the Plat of Oakridge, Lane County, Oregon, thence South 87° 05' East 190 feet along the North line of Second Street; thence North 2° 55' East 157 feet; thence North 87° 05' West 190 feet to a point due North of the point of beginning; thence South 2° 55' West 157 feet to the place of beginning, being in Section 16, Township 21 South, Range 3 East of the Willamette Meridian, Lane County, Oregon (map # 21-35-16-25-00500).

WHEREAS said real property is owned by Lane County and not in use for County purposes, and sale of said property would benefit Lane County by its return to the tax roll, and

WHEREAS said parcel was offered at a Sheriff's sale on December 9, 2002 with a minimum bid of \$8,000 and

WHEREAS no bids were received for said parcel and it remained unsold at the close of said sale

IT IS HEREBY ORDERED that pursuant to ORS 275.200 and ORS 275.275, the parcel be sold to Mark Kimball Mathis for \$6,000, that the Quitclaim Deed be executed by the Board and that the proceeds be disbursed as follows:

Foreclosure Fund	(228-5570270-446120)	\$5,950.00
General Fund	(124-5570260-436521)	50.00

IT IS FURTHER ORDERED, that this Order shall be entered into the records of the Board of Commissioners of the County.

DATED this 21st day of Jan, 2003.

Chair, Board of County Commissioners

APPROVED AS TO FORM

Date 1-9-03 Lane county

OFFICE OF LEGAL COUNSEL

IN THE MATTER OF AUTHORIZING THE SALE OF SURPLUS COUNTY OWNED REAL PROPERTY TO MARK KIMBALL MATHIS FOR \$6,000 (MAP # 21-35-16-24-00500, OAKRIDGE)

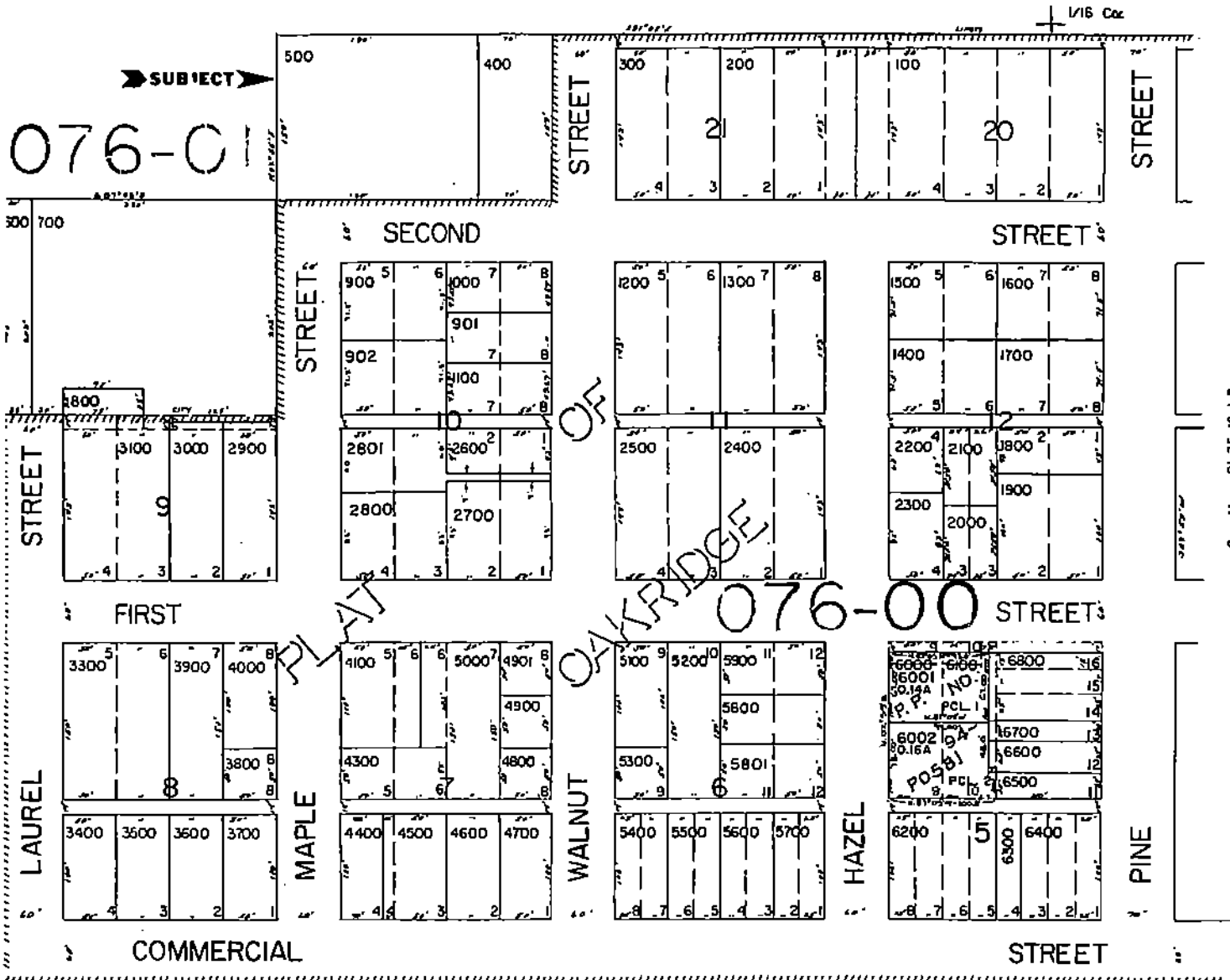

See Map 21 35 16 1 3